

ELEIKO SCHOOL BARBELL RACK

Art.no. 3060425

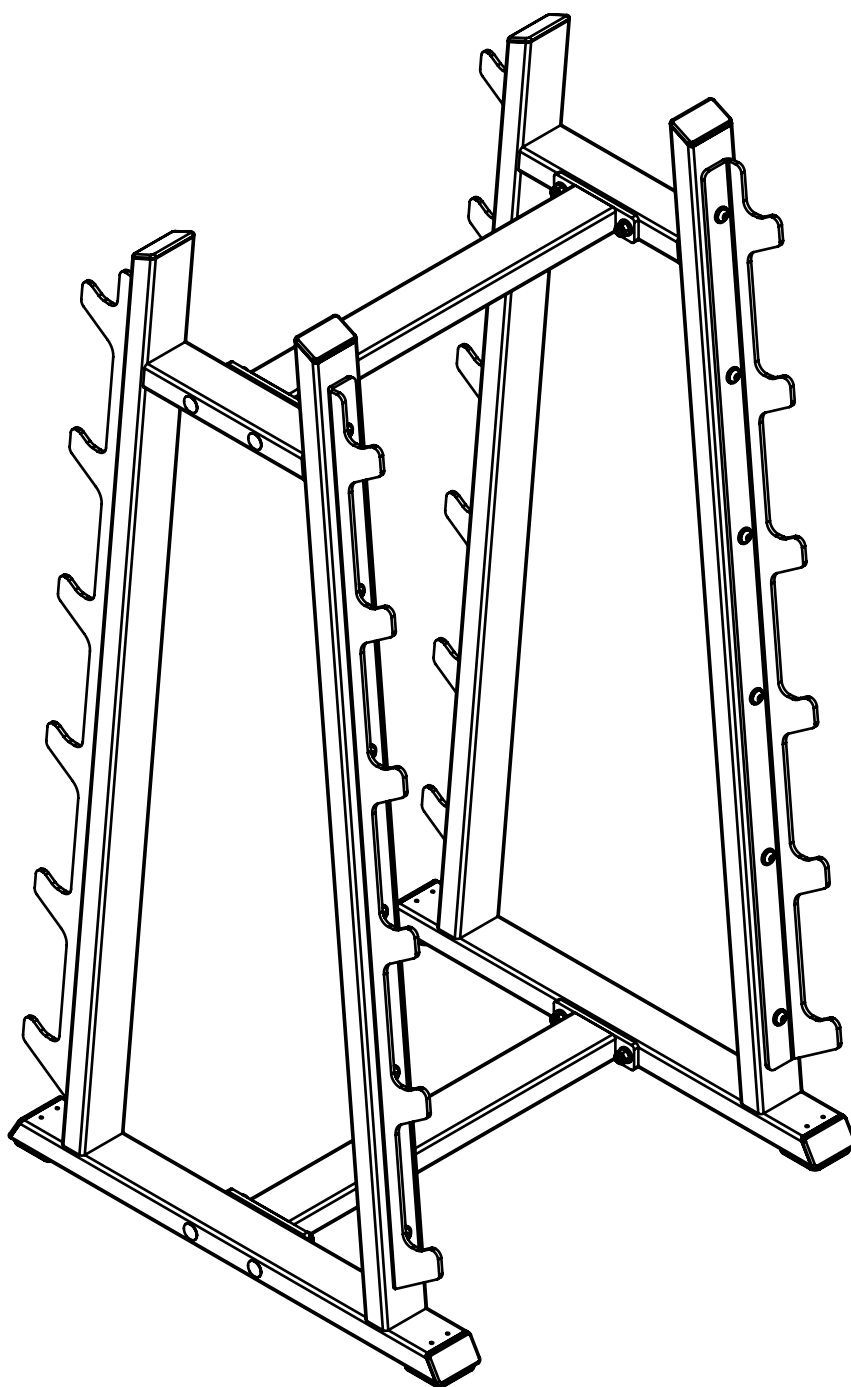

READ BEFORE INSTALLATION AND USE

CAUTION

The equipment must be installed and used in a place whose access and supervision are specifically controlled by the owner.

Be sure to install the equipment on a stable base and properly level the equipment. ELEIKO recommends that all equipment is secured to floor and installed by a licensed contractor or an ELEIKO-installer.

SAFETY INSTRUCTIONS

It is the responsibility of the purchaser of ELEIKO products to instruct all users and supervising personnel on proper usage of the equipment.

1. All included warnings (labels) and instructions MUST be read before the use of any ELEIKO-equipment. Use each equipment as it is intended for.
2. A user MUST get a medical examination and proper instructions before the use of any ELEIKO-equipment.
3. DO NOT let anyone, under any circumstances, use equipment that appears to be damaged. Do not try to repair any equipment before consulting an ELEIKO technician.
4. DO NOT replace the components of ELEIKO-equipment with other none ELEIKO-equipment (magnetic safety pin, frames, bars), do not improvise. If there are any doubts consult an ELEIKO representative prior to any intervention.
5. DO NOT overload the equipment and DO NOT try to exceed personal strength levels.
6. Keep children under the age of 14 away from the equipment and teenagers must be supervised.
7. DO NOT remove any safety labels from the ELEIKO-equipment. ELEIKO is not responsible if a label is removed. Replace damaged labels immediately.

PREVENTITIVE MAINTENANCE & INSPECTIONS

REGULARLY:

Clean the surfaces on frames and tubes from dust and dirt.

Check that all bolts between parts, walls, floors are properly tightened, according to recommendations.

WARRANTY

All products manufactured by ELEIKO Inc. are warranted to the original purchaser to be free from defects in workmanship and / or materials under normal use as follows:
5 years on welds on structural frame (NOT on moving parts)

ADDITIONAL INFORMATION

This equipment is for indoor use only.

PRODUCT SPECIFICATIONS

This product is used for storage of 12 School Barbells 10-50 kg.

Product weight	74 kg / 163 lbs
Max user weight	---
Max training weight	350 kg / 772 lbs
Dimensions (L x W x H)	782 x 807 x 1570 mm / 31" x 32" x 62"

FOOTPRINT AREA

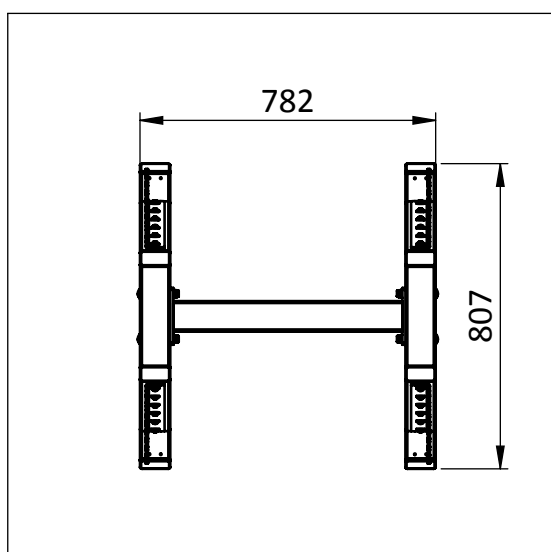

Add sufficient clearance, not less than 0,6 m, on all sides. Taking into account the accessibility to remove and replace school barbells.

CONTENTS

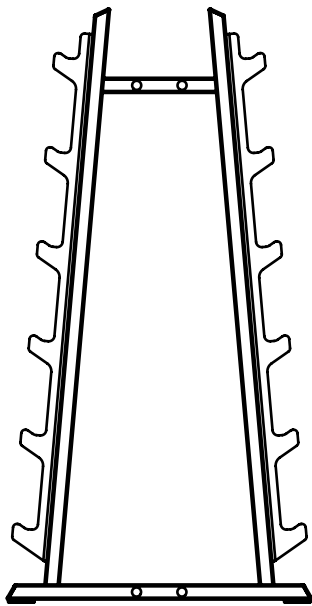

Leg

x2

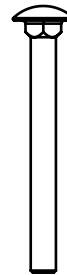

M10 x 100

x8



M10 nut

x8

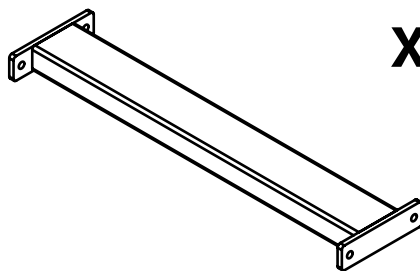

Center beam

x2



Washer 10

x8

Required tools:

- spanner size 16 (or monkey key)

ASSEMBLY INSTRUCTIONS

1.

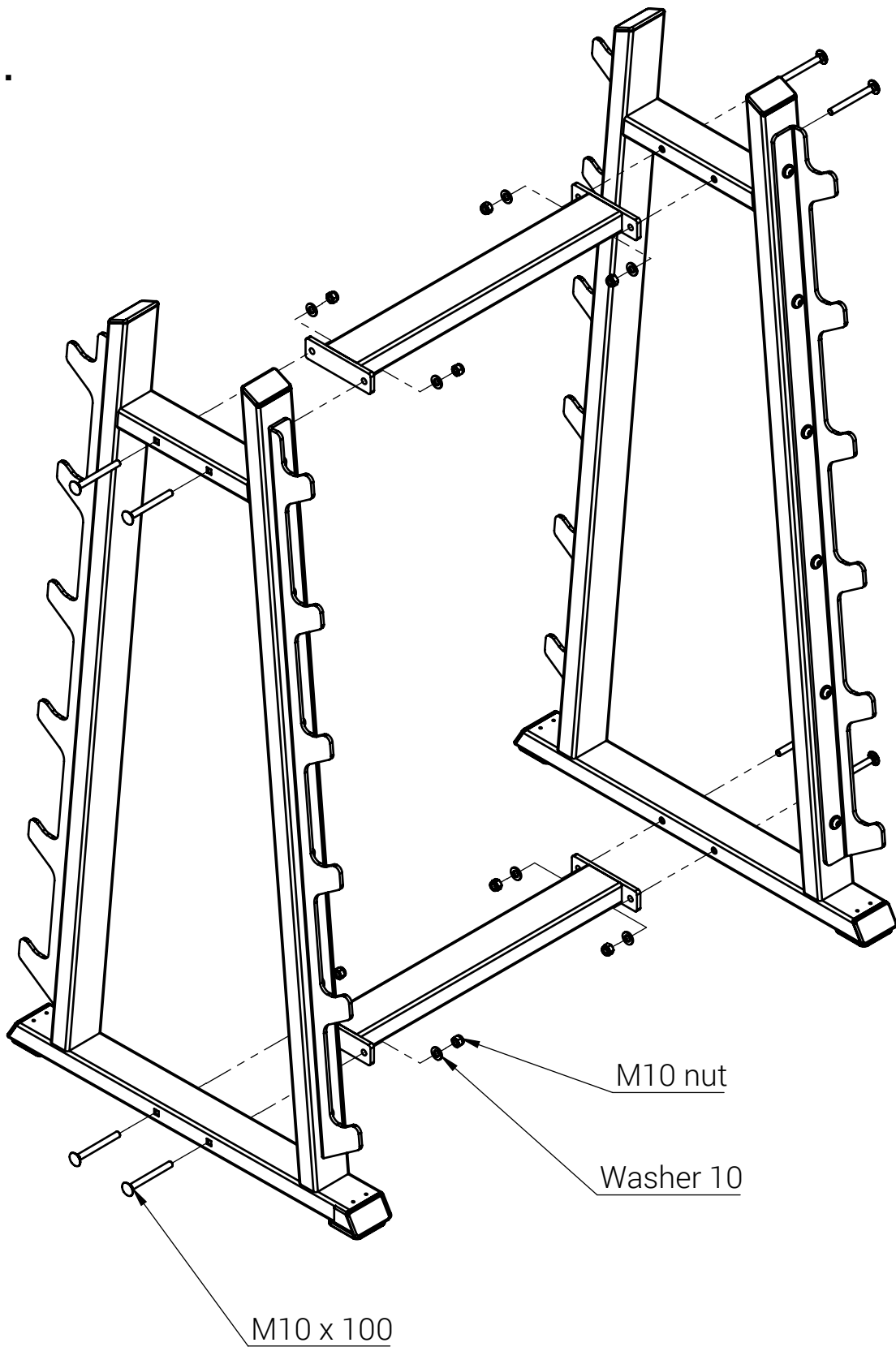

FLOOR ATTACHMENT

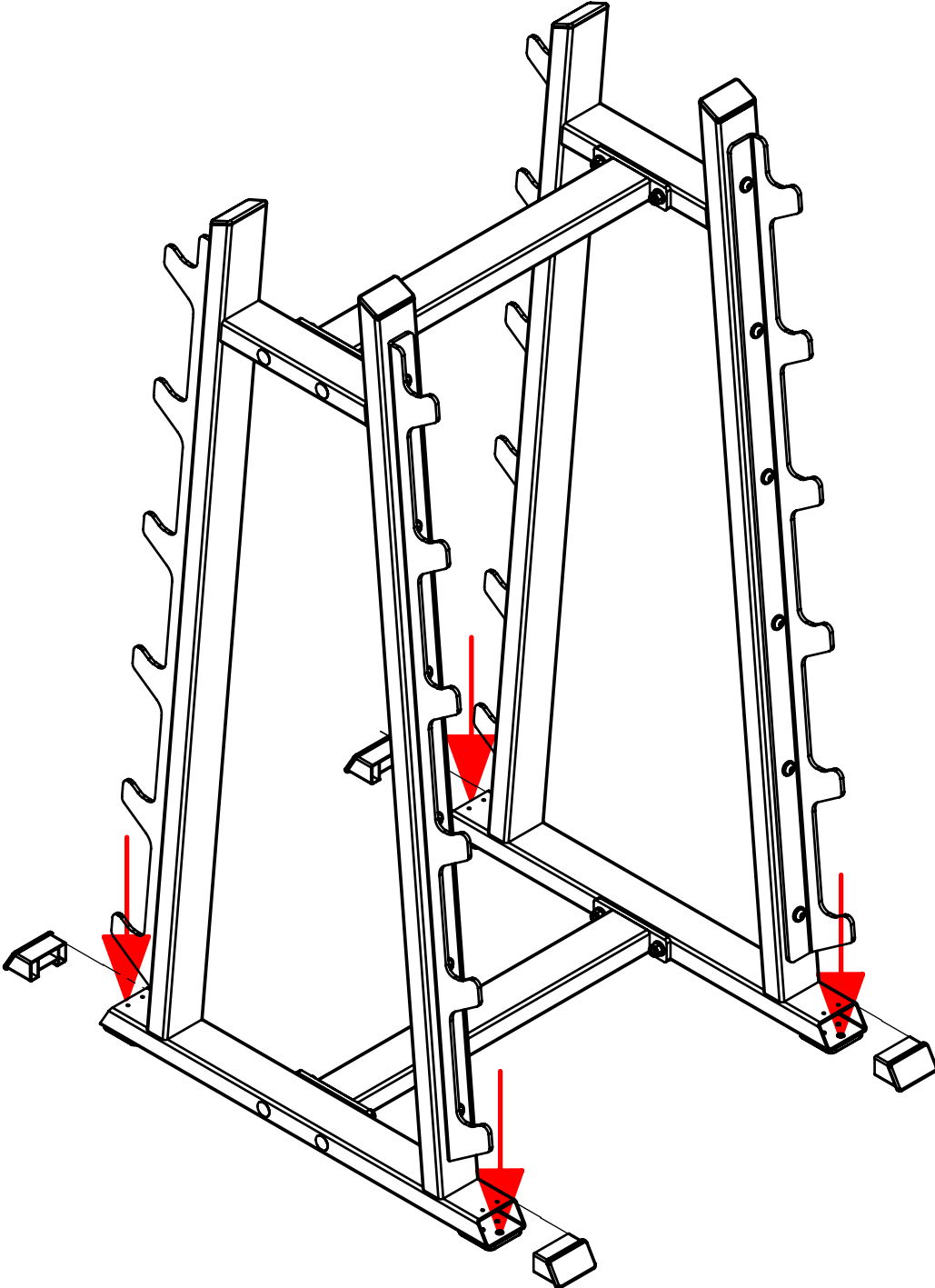



Eleiko Group AB | Korsvägen 31 | SE-302 56 HALMSTAD | Sweden
E-mail: info@eleiko.com | Phone: +46 35 17 70 70

www.eleiko.com